

THE ORCHARD at DIREK

Stage 9

Allotment Development Plan

Key Plan
Scale 1:2500

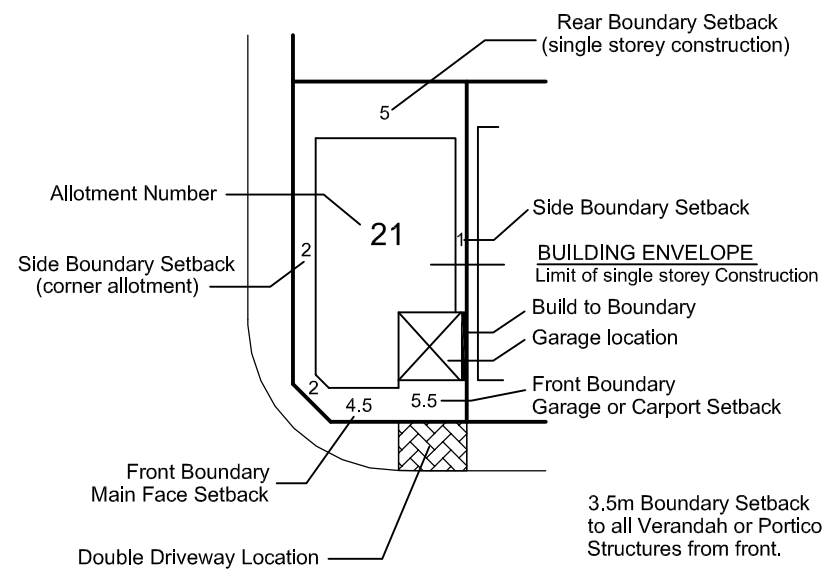

NB: The Allotment Development Plan must be read in conjunction with the written guidelines

NOTE:
SUBJECT TO CONFIRMATION OF EASEMENTS.
Road layout and associated infrastructure is indicative only.
Building on the boundary subject to council consent.

REVISION	DATE
0 ISSUED FOR INFORMATION	01/04/11
1 INTERNAL BOUNDARIES ALTERED	14/10/15

	FYFE Earth Partners ACN 008 116 130 LEVEL 3, 80 FLINDERS STREET, ADELAIDE, SA, 5000 GPO BOX 2450 ADELAIDE SA 5001 TEL (08) 8201 9600 FAX (08) 8201 9650 E-mail info@fyfe.com.au
	REVISION : 1 DRAWING : 20203B07-R1 FILE No : 20203-1-101 DATE OF ISSUE : 14/10/2015 DRAWN : KGH CHECKED :

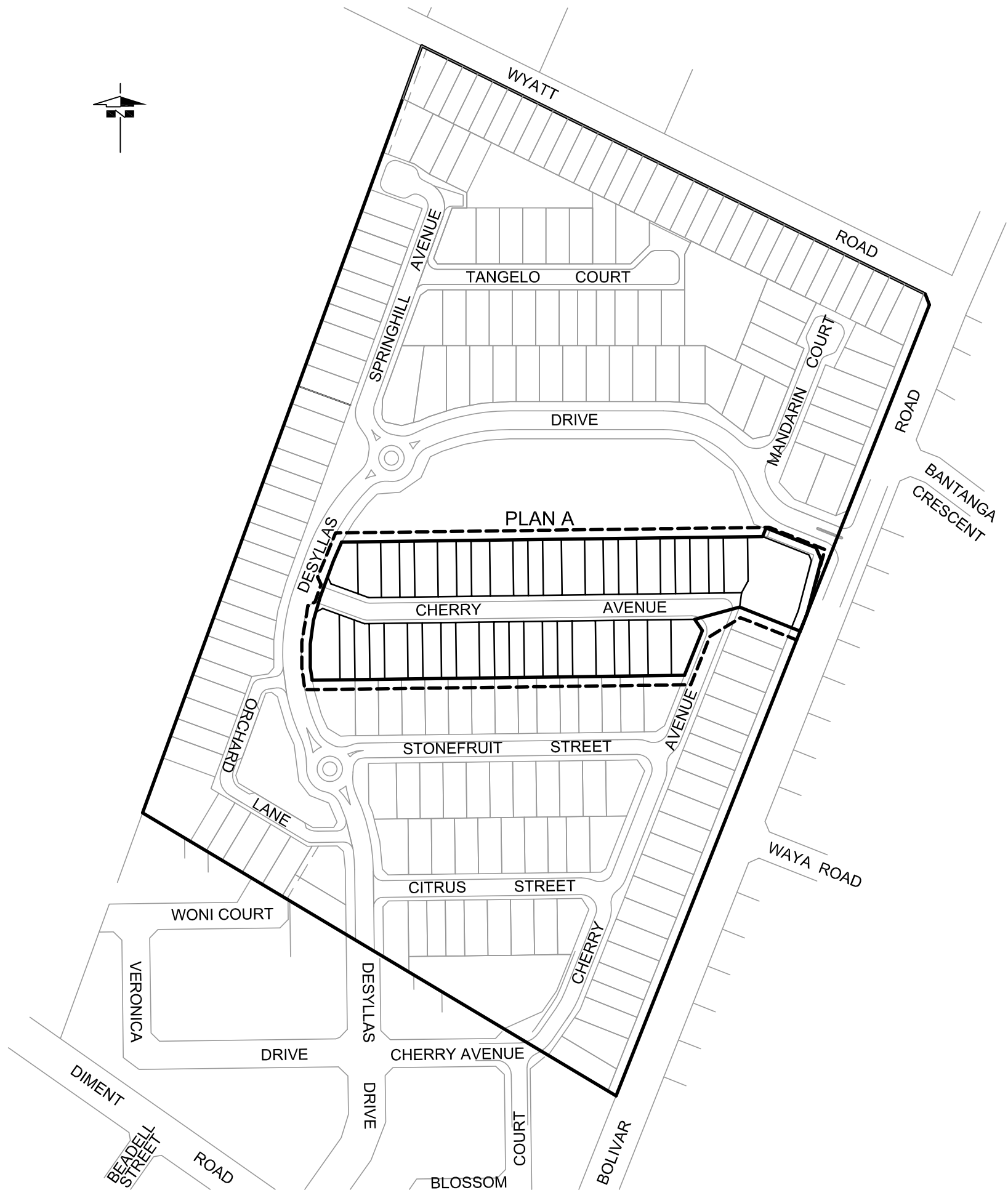

THE ORCHARD at DIREK
Stage 9
Allotment Development Plan

Plan A
 Scale 1:750



500
RESERVE



REVISION	DATE
0 ISSUED FOR INFORMATION	01/04/11
1 INTERNAL BOUNDARIES ALTERED	14/10/15

	FYFE Earth Partners ACN 008 116 130 LEVEL 3, 80 FLINDERS STREET, ADELAIDE, SA, 5000 GPO BOX 2450 ADELAIDE SA 5001 TEL (08) 8201 9600 FAX (08) 8201 9650 E-mail info@fyfe.com.au
	REVISION : 1 DRAWING : 20203B07-R1 FILE No : 20203-1-101 DATE OF ISSUE : 14/10/2015 DRAWN : KGH CHECKED :