

FIXED PRICE

House and Land Package

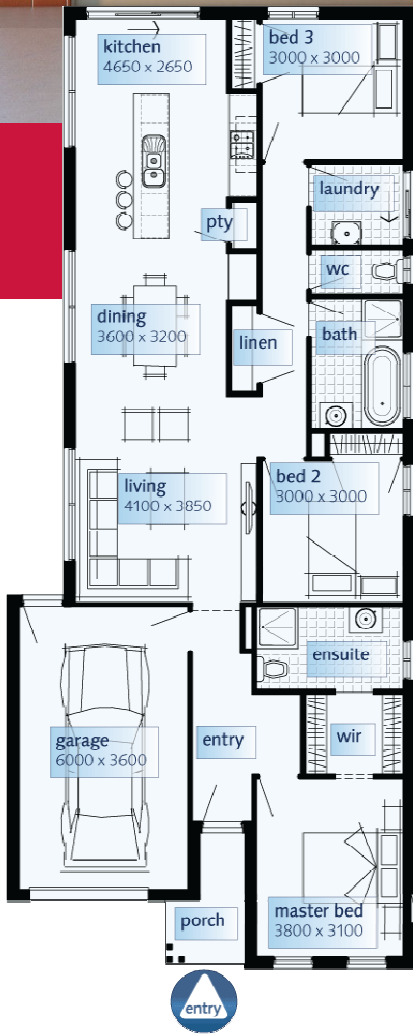

Simonds Homes does not provide fencing or landscaping



Isis

3 2 1

16 sqs

56 De Mille Street (329m²)
Peartree Grove, Salisbury Downs SA 5108

NOW \$326,935

FIXED PRICE HOUSE AND LAND PACKAGE INCLUDES:

- Fixed Site and Footings Costs; no hidden extras!
- Upgraded Mossman Facade (6 Facades available)
- Render to Frontage, Remote Panel Lift Garage Door
- LED Downlights to Living Areas
- Quality Fixtures; 900mm SS European Appliances
- Overhead Cupboards to Kitchen, Upgraded Laundry Joinery
- Walk in Robe to Master Bedroom, Built in Robes to Bedrooms
- Timber Finish Floating Floor and Carpet throughout
- Coloured Concrete Driveway and Perimeter Footpath
- Rainwater Tank, Pump, Plumbing, Full Stormwater System
- Samsung Ducted Reverse Cycle Heating and Cooling System
- Land Sale (\$159,950) by Century 21 Special Projects RLA2140

For more information please contact

Haydn Yates - 0438 330 133

Finance to approved applicants only. Images shown for illustrative purposes only and may not represent the final product. Prices are based on availability and price of land. Simonds reserves the right to alter any price or substitute any home without prior notice. All house and land packages are subject to developers' final approval. In the event that a homesite does not have survey pegs in place to identify a boundary lot then an additional charge will be added to the cost of the house. No allowance for the BAL is included unless stated otherwise.

July 2015

