

GAWLER ROAD

Lewiston
RURAL LIVING
SALE PLAN
02.02.2023

BETHESDA ROAD

ROAD

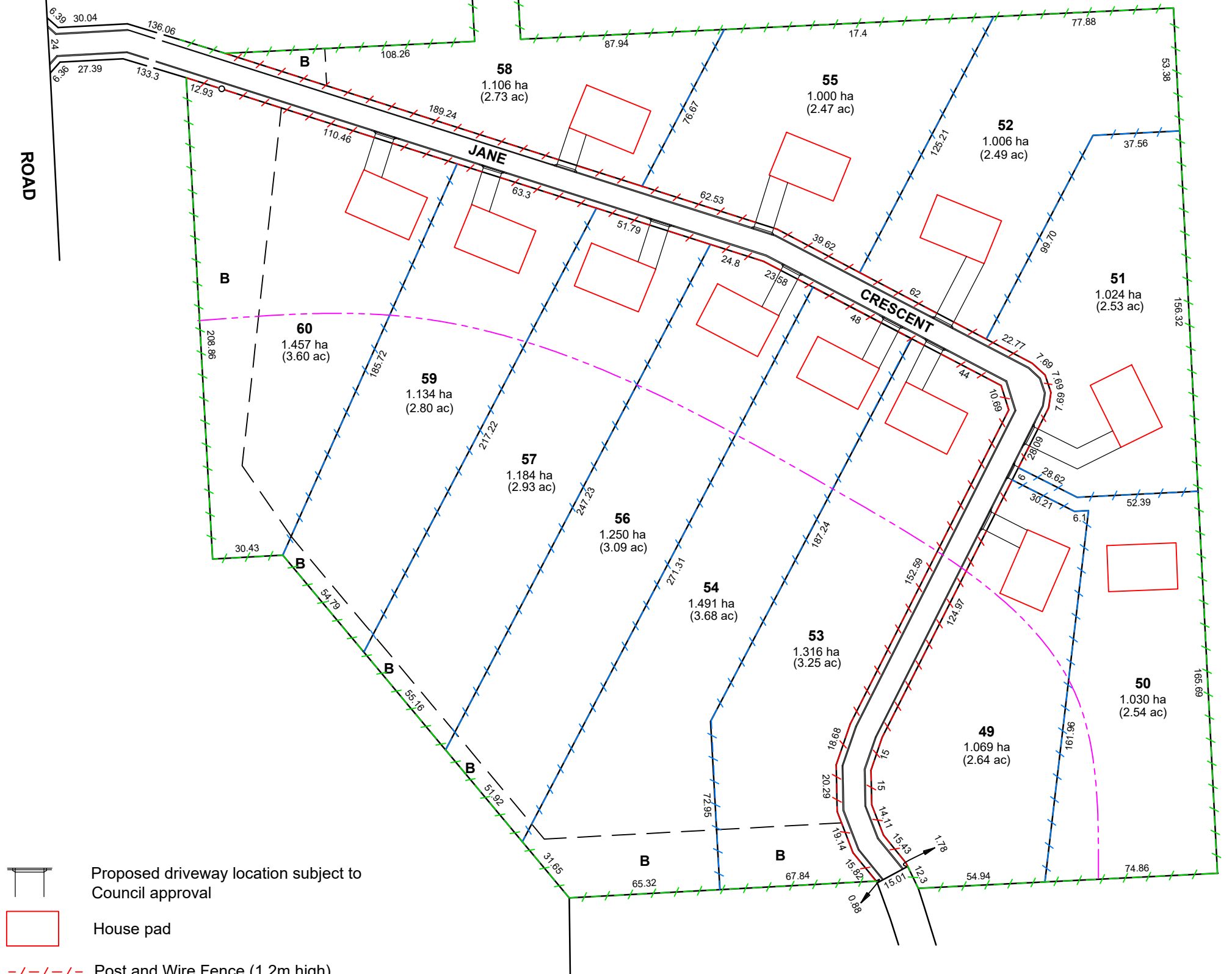

Proposed driveway location subject to Council approval

House pad

Post and Wire Fence (1.2m high) to be provided by Developer

Post and Wire Fence (1.2m high) to be provided by Purchaser

Fencing 'as is'

No fill South or West of this line

1. Data shown hereon is subject to approval by Council, State Commission Assessment Panel and acceptance by the Registrar General of Titles.

2. The portions of land marked B are subject to a stormwater easement to Council.

22A2302SALE(D)

